

1X2 Optical Switch

Key Features

- * Wide Operating Wavelength Range
- * Low insertion loss
- * Bi-directional Operation
- * Excellent stability and reliability

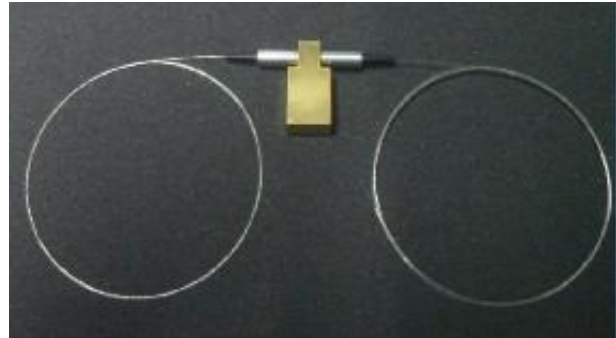

Applications

- * Optical network protection & restoration
- * Re-Configurable OADM
- * Instrumentation, Testing & Measurement

Specifications

Parameter	Unit	Specification	
Wavelength range	nm	1260~1610	
Switch type		Latching	Non-Latching
Insertion loss	dB	≤0.80	
WDL	dB	≤0.25	
Return loss	dB	≥50	
Cross talk	dB	≥55	
PDL	dB	≤0.05	
Repeatability	dB	≤±0.03	
Switching speed	ms	≤8	
Operating voltage (VDC)	V	5	
Durability	Cycle	>10 ⁷	
Handling power	mw	500	
Operating temperature	°C	0~70	
Storage temperature	°C	-40~85	
Fiber type	/	SMF-28e	
Dimensions	mm	27(L) x 12.6(W) x 8.2(H)	

* IL is 0.3dB (1310~1550nm) higher, RL is 5dB lower for each connector added.

Electrical Configuration

Latching Type

Optical Path	Electric Control				Status Sensor			
	PIN1	PIN5	PIN6	PIN10	PIN2-3	PIN3-4	PIN7-8	PIN8-9
P1-P2	V+	GND	-	-	open	close	close	open
P1-P3	-	-	GND	V+	close	open	open	close

NON-Latching

Optical Path	Electric Control		Status Sensor			
	PIN1	PIN10	PIN2-3	PIN3-4	PIN7-8	PIN8-9
P1-P2	V+	GND	open	close	close	open
P1-P3	-	-	close	open	open	close

Mechanical Dimension (Unit: mm)

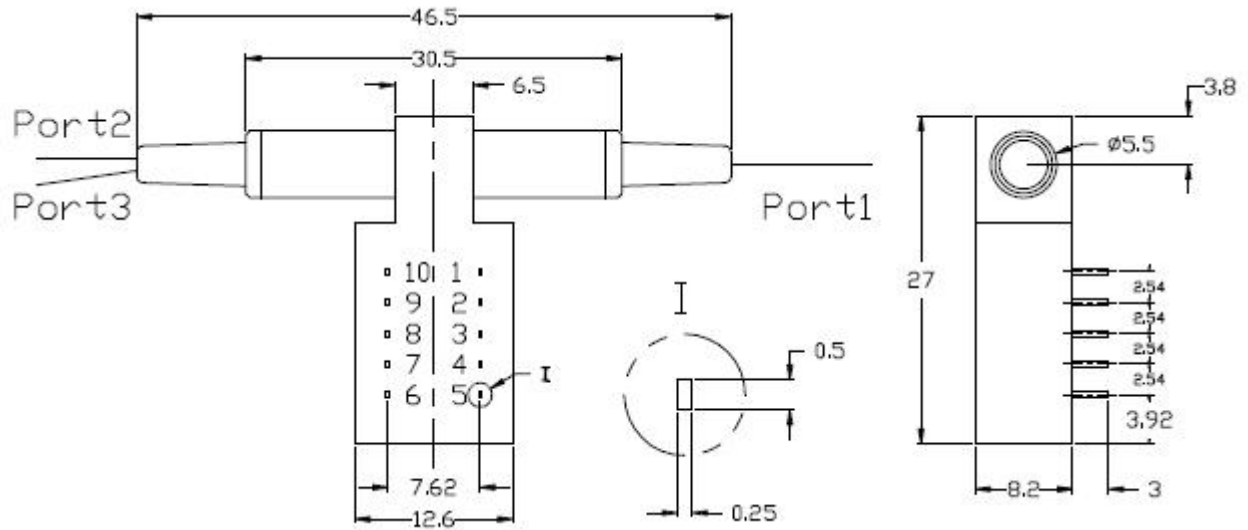

Ordering Information

